

Instruction Guide

Klick-Fit Acrylic Curtain Pole Kit

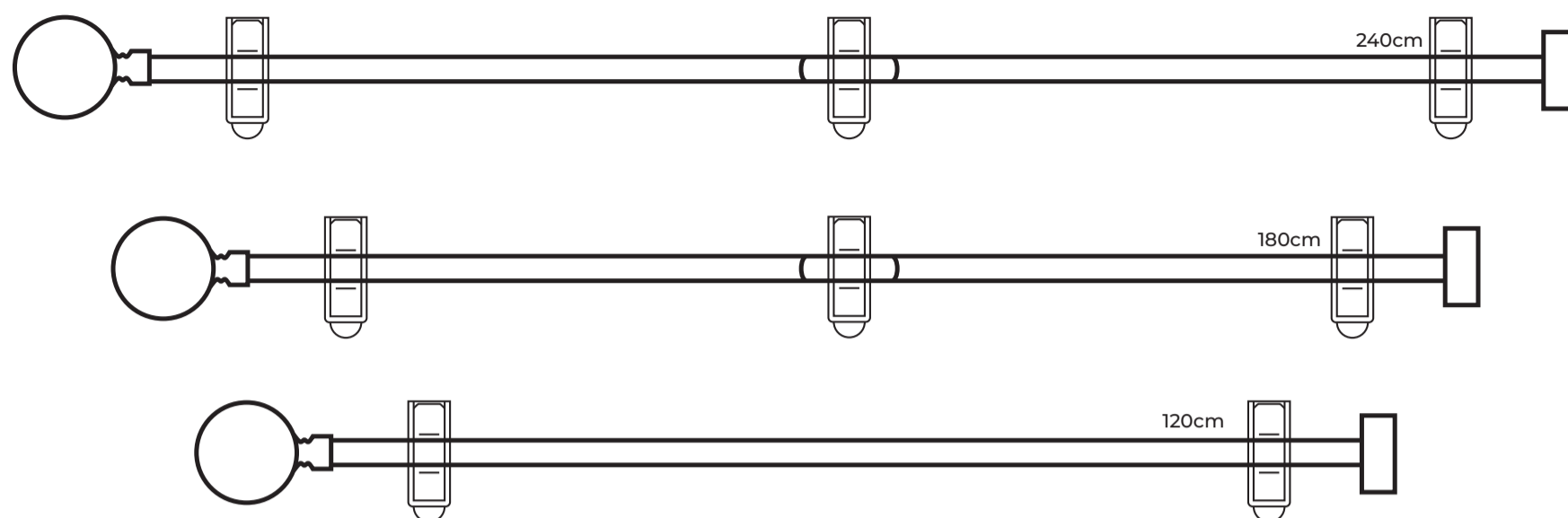

Before You Start



Before installing please identify that you have all the parts as listed below.

Warnings

- Proper fitting of this item is extremely important.
- This is suitable for DIY fitting however if the necessary tools and expertise are not available, we would recommend installation by a qualified trades person.
- Ensure that your wall is in sound condition prior to fitting & check that no hidden pipes or cables will interfere when installing.
- We suggest you retain these instructions for future reference. This product should only be used on solid mounting at the point of fixing. This is necessary to take the weight of the curtain pole with curtain. Please periodically check all fittings and re-tighten as necessary.
- Unwrap all packaging material and place the components on top of the carton box or on a clean floor to protect from damage.
- The screws & wall plugs provided are for plasterboard partitions or masonry walls.

Do's

- We suggest you spend a short time reading through this leaflet before you begin and make sure that you have the right tools and plenty of space.
- Carefully check that you have all the parts before beginning assembly.
- Due to the size of the product we recommend that it is assembled in the room intended for use.
- Ensure the product is fully assembled as illustrated and all fixings are fully tightened before use.
- Wipe occasionally with a clean soft cloth lightly.
- Ensure eye protection is worn throughout the installation.

Don'ts

- Do not use abrasive materials as these will affect the coating.

www.rothley.com

Visit our website more matching product ranges and accessories

v1-280524

Parts Included

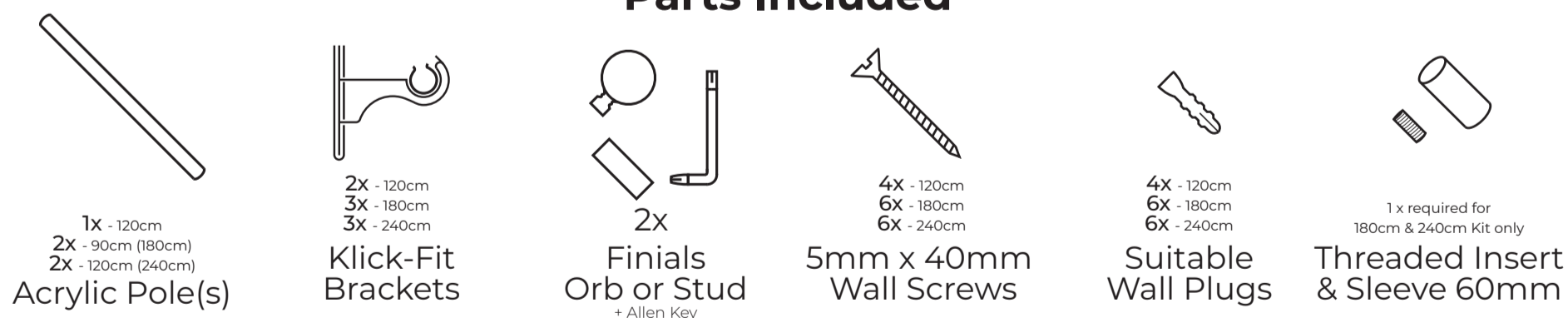

Tools that you might need

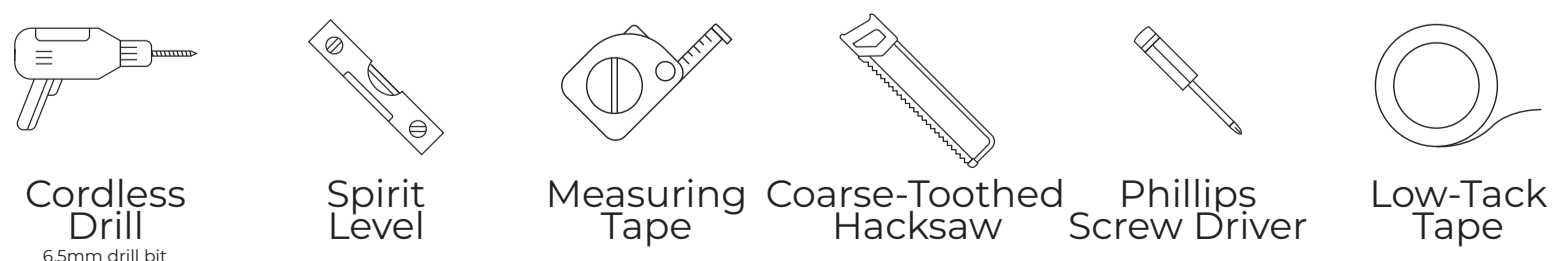

IMPORTANT! Before fitting ensure that there is a minimum clearance of 3.7cm from the top of the backplate to the underside of the ceiling, any less than this the bracket cannot be fitted.

Step 1

Measure at least 10cm across from the window edge and 10cm up using a pencil mark the bottom of the Back Plate of the Bracket.
All Backplates should be at the same height

Step 2

Using a spirit level check the Back Plate is straight and mark the holes using a pencil.

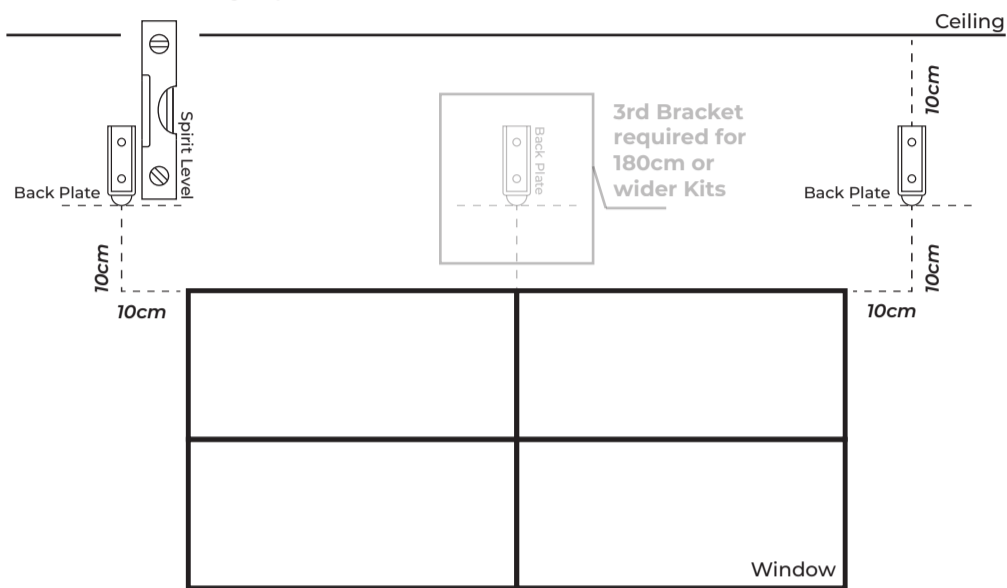

Step 3

Drill 40mm deep holes using a 6.5mm drill bit.

Making sure to keep the drill parallel with the wall at all times

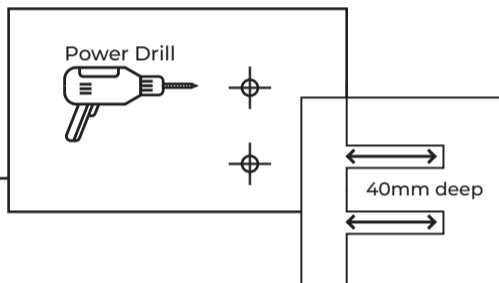

Step 4

Insert the Wall Plugs into the holes and screw the backplates to the wall.

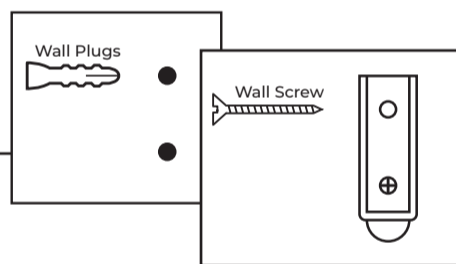

Note: If your Curtain Pole kit has only 1 pole you can skip step 6

Step 6

Slide the sleeve over one end of the curtain pole then carefully screw the threaded insert into the end of the other curtain pole. Then proceed to screw both poles together.



Step 7

For curtains with eyelets, thread the pole through the eyelets leaving one eyelet to the left of the support Bracket, on the left-hand side of the pole, and one eyelet to the right of the support Bracket, on the right-hand side of the pole, to hold the curtain in place.

Step 8

For curtain rings slide them on the pole, keeping two aside to be placed on each side of the Brackets.

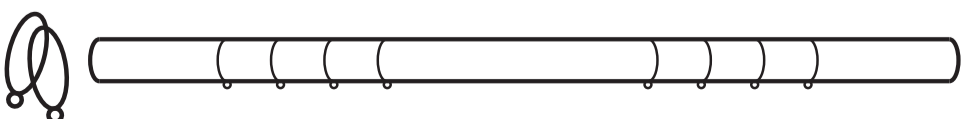

TIP: You will require a minimum of 9.7cm clearance from the top of the backplates to the underside of the ceiling to install the brackets if 9.7cm clearance is not achievable, please carry out the following:

- 1/ Remove the bottom screw on the backplate.
- 2/ Slightly loosen the top screw.
- 3/ Carefully rotate the backplate either clockwise or anticlockwise (Be careful that you do not damage the wall when rotating the backplate)
- 4/ Insert the bracket and return the backplate to the vertical position ensuring the bottom hole is aligned with the previous fitted wall plug.
- 5/ Insert screw and tighten the backplate to the wall

Note: The minimum clearance from the top of the Backplate and underside of the ceiling is 3.7cm, any less than this the Bracket cannot be fitted.

Step 5

Slide the brackets into the backplates

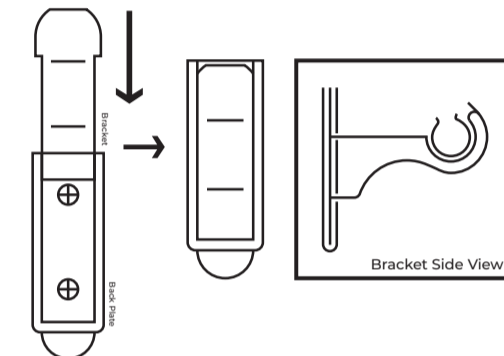

CUTTING THE ACRYLIC POLE

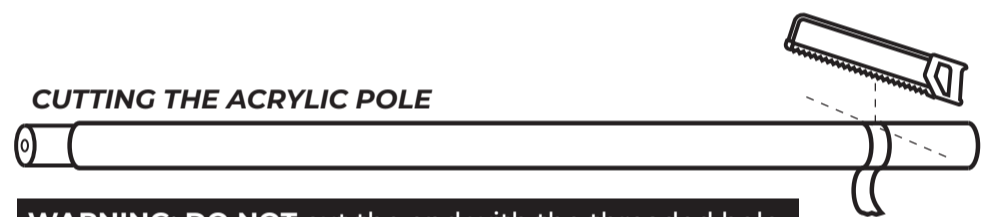

WARNING: DO NOT cut the end with the threaded hole.

Mark the point at which the pole needs to be cut and wrap a low-tack tape around the pole covering the position of the intended cut to prevent the hacksaw blade from slipping and scratching the Curtain Pole.

Use a Coarse-toothed hacksaw for best results

Step 9

Rest the pole across the wall Brackets then simply "Klick" into place.

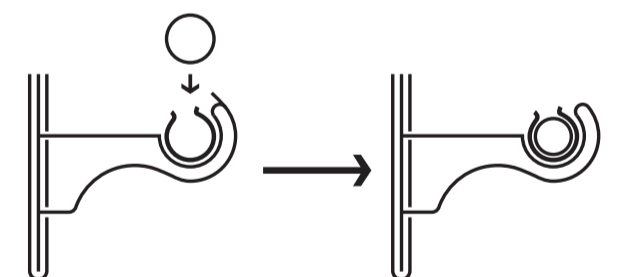

Step 10

Place a Finial on each end of the pole and tighten the grub screw using the Allen key provided

Repeat this step on both ends of the pole

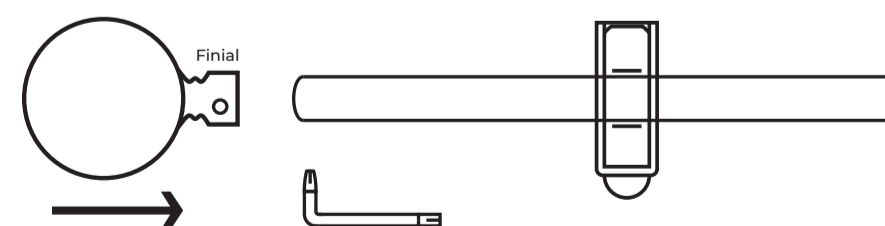

www.rothley.com

Visit our website more matching product ranges and accessories