

# ROTHLEY

## Instruction Guide

Handrail Kit

1.2m

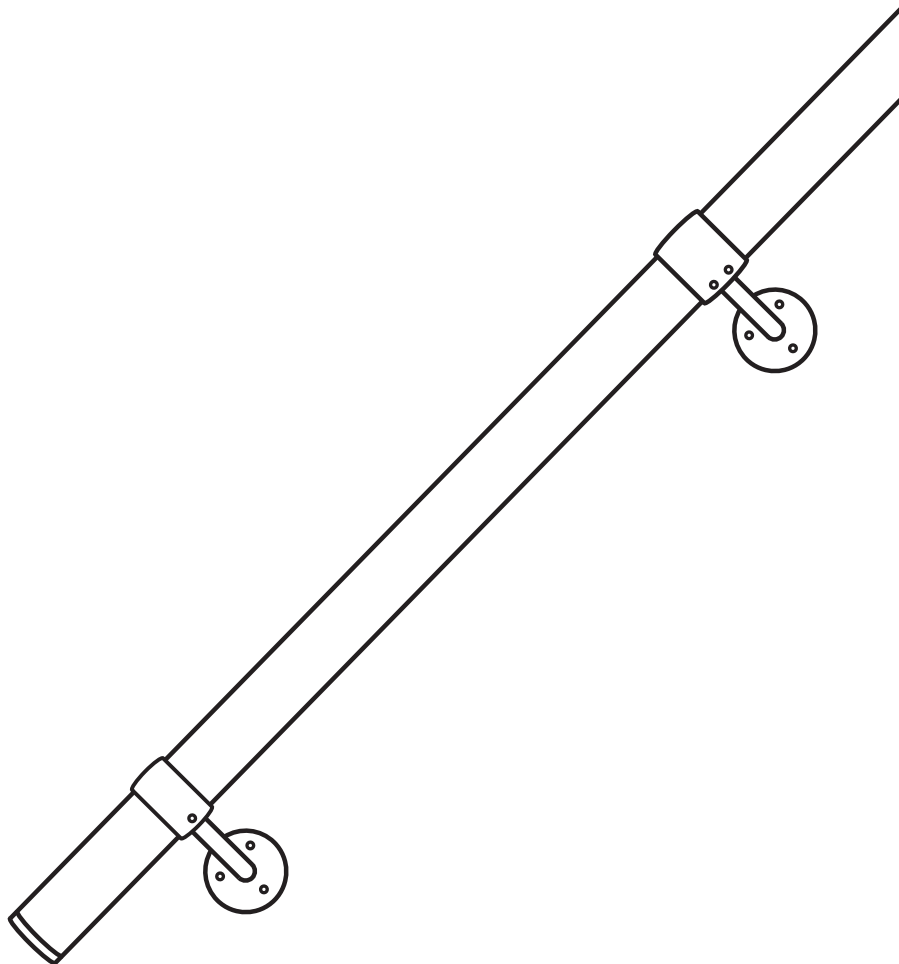

@RothleyLtd



## Accessorising your home

[www.rothley.com](http://www.rothley.com)

### IMPORTANT INFORMATION

Before Installing please identify that you have all the kit parts as listed on page 2.

---

**Rothley Handrail kits** are designed for **domestic** use **ONLY**.

**Rothley Handrail Kits** are suitable for **indoor** use **ONLY**.

**Before** installing please check the wall surface is **solid** and in **sound condition**.

**Wall Plugs** included are for use in **solid masonry walls ONLY** and may not be suitable for your application. Please **ensure** you use the **correct wall plugs** suitable for your application.

**Before drilling** ensure there are **NO pipes** or **cables** located in the wall that could interfere with installation.

**Handrail** should **NOT** be fitted to **plasterboard** partitioning.

## Kit Parts

### Included

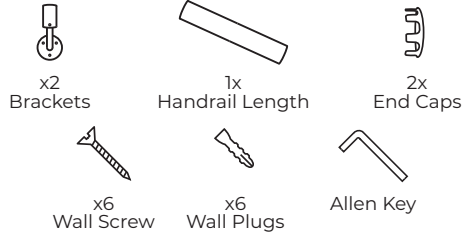

### Required Extras

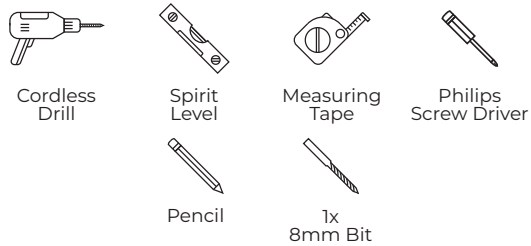

## Step 1

Using a **pencil** and **Spirit Level** mark **3 points** vertical lines on the wall at the bottom, top & centre of the stairs that are **805mm** from the edge of the step.

Using a **straight edge** connect the points together until you have a **unobtrusive line** that goes from the bottom to the top of the stairs.

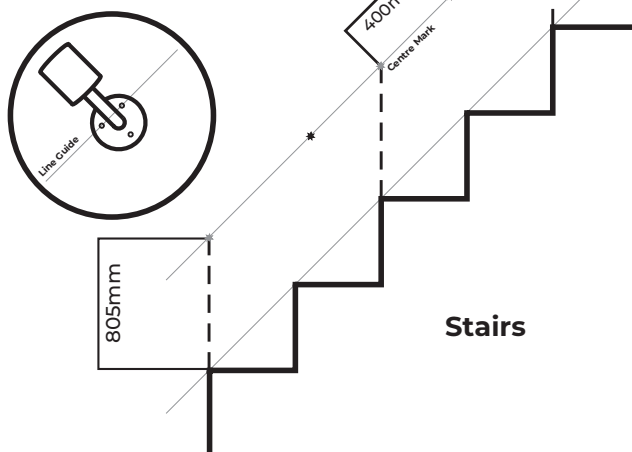

### Step 2

Locate the centre position of the stairs and **measure 400mm** in the elevated position and use the three holes on the base of the **Bracket** to **mark** the holes with a pencil.

***\*\*top two holes should follow the line guide\*\****

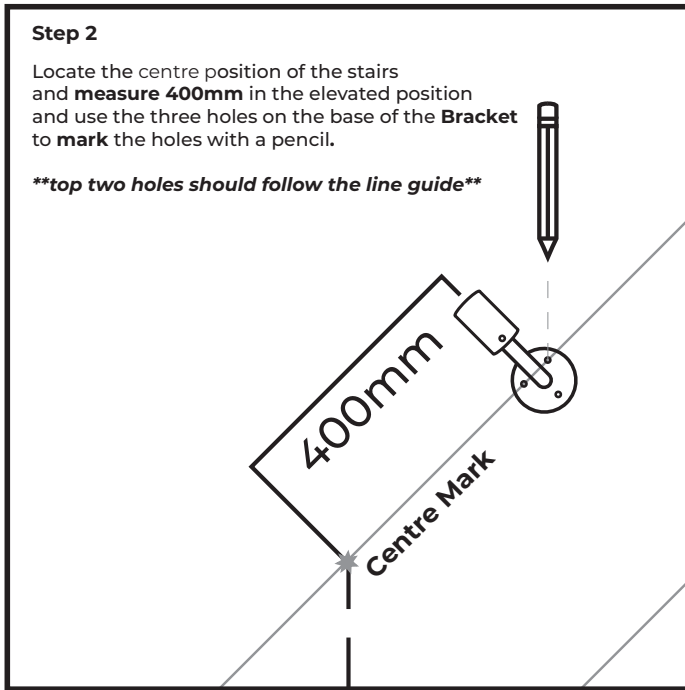

### Step 3

Using a **Drill** with a **8mm bit**, drill holes **50mm deep** and insert the **included wall plugs**.

***\*\*wall plugs included are for use in solid masonry walls ONLY and may not be suitable for your application. Please ensure you use the correct wall plugs suitable for your application.\*\****

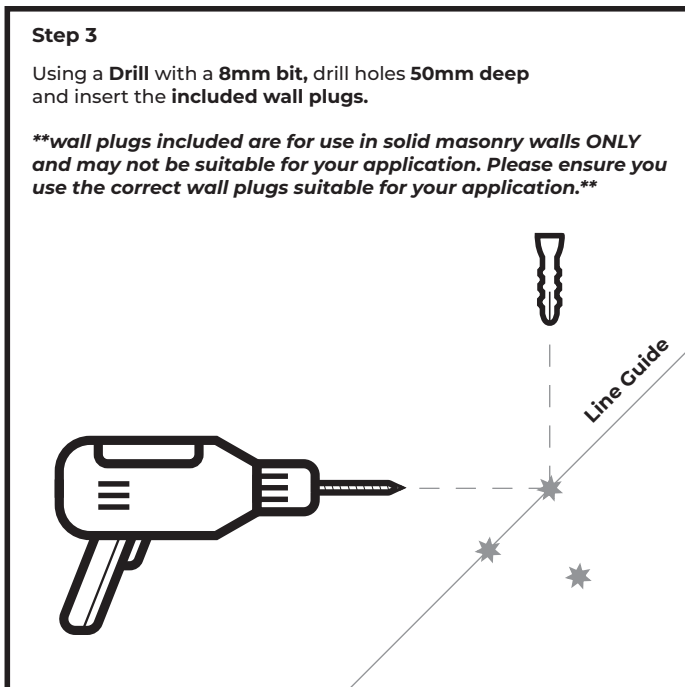

#### Step 4

Now return the **Bracket** to the wall and insert the **50mm screws** checking they are tight.

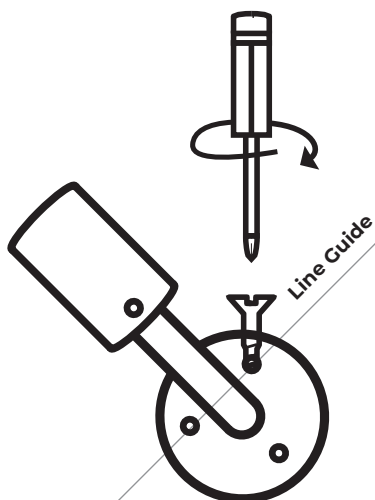

#### Step 5

Place a length of **Handrail** into the installed **Bracket** and another 2nd **Bracket** onto the end of the **Rail**.

Align the top two holes on the **Bracket** with the line guide and mark all three fixing holes on to the wall.

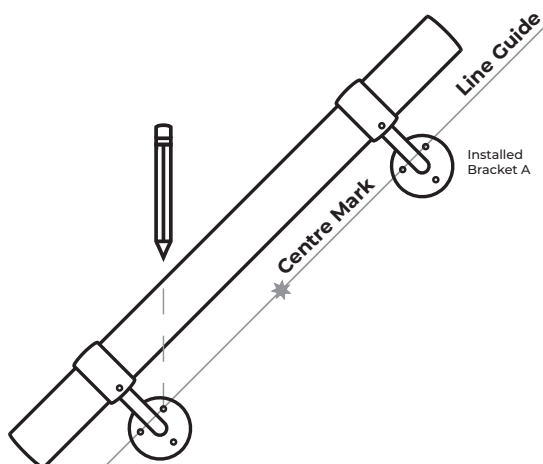

### Step 6

**Drill** all three **8mm x 50mm** Deep holes into the wall and insert Wall Plugs included.

Re-insert the **Rail** and **Bracket** onto the end of the **Rail** and screw **Bracket** to the wall.

**\*\*Ensure screws are tight\*\***

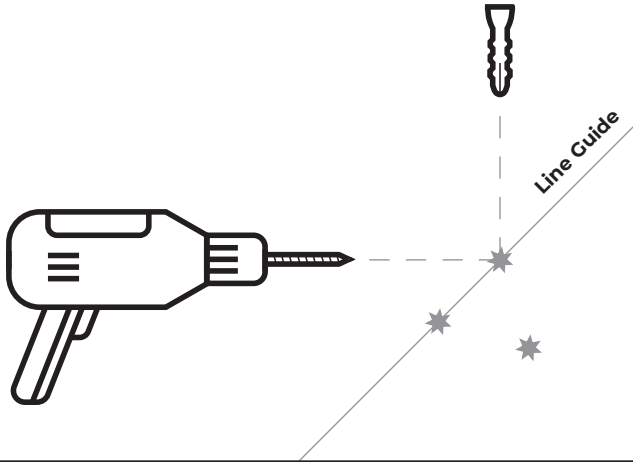

### Step 7

Making sure the rail has 200mm either end of the hand rail use the included Allen key, tighten the pre installed **Grubscrew**. Repeat this on the other end of the rail to hold the rail in place.

**\*\*Ensure the Grubscrews are tight\*\***

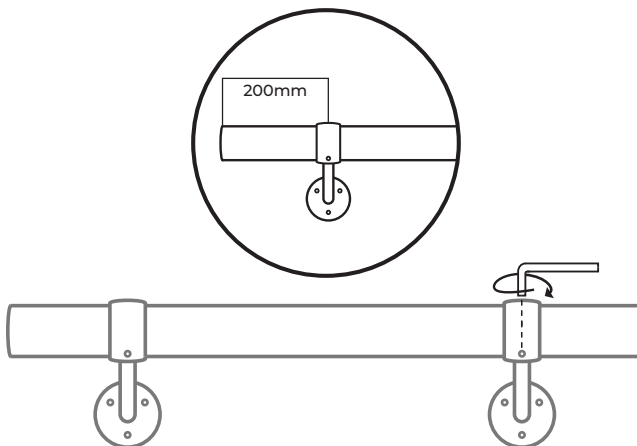

### Step 8

The **Handrail** should now look like this.  
If not please re-read the instructions

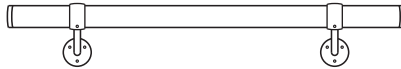

To fit the **End Caps** push them on the the end of the rail  
untill they are fully inserted.

***\*\*Do this to both ends of the Handrail\*\****

